

KS1000

MINI SKID STEER

DIMENSIONS (STD)	U.S.(in)	METRIC
A Operating height, max std. bucket	117in	2980mm
D Overall length of machine, std. bucket	117in	2980mm
E Overall length of loader, no attachment	83.5in	2120mm
C Overall machine height	56in	m
Machine weight (no attachment, fluids full)	3306lb	1420mm
Operating capacity		1780kg
35% tipping capacity	1020lb	462kg
Tipping capacity	2914lb	1320kg
B Hinge pin height, max	87in	2220mm
F Wheelbase/ track length	46.5in	1180mm
Ground clearance, min		
Center	5.7in	145mm
J Angle of departure	33°	
P Overall width	36.7in	932mm
Q Total track width	36.2in	920mm
R Track width	7in	180mm

POWER

Model No.	Kubota D1703	
Fuel	Diesel	
Gross power rating	24.7hp	18.2kW EU
Emissions compliance	EPA Tier 4	Stage V
Number of cylinders	3	
Displacement	100.5in ³	1.647L
Bore	3.46 in	87mm
Stroke	3.64 in	92.4mm
Rated speed	2,200rpm	

OPERATION

Ground drive speed		
Forward/Reverse	4mph	6.5km/h
Ground pressure(ISO/CD 16754) 9- in(230-mm)tracks	4.5psi	0.31bar

HYDRAULIC SYSTEM

Auxiliary circuit		
Gear pump		
Flow rate (pump #1)	15gpm	56.8L/min
Pressure	3,190psi	220bar
Dual hydrostatic ground drive pumps		
Flow rate	22.1gp	83.6L/min
Pressure	m 3, 190psi	220bar

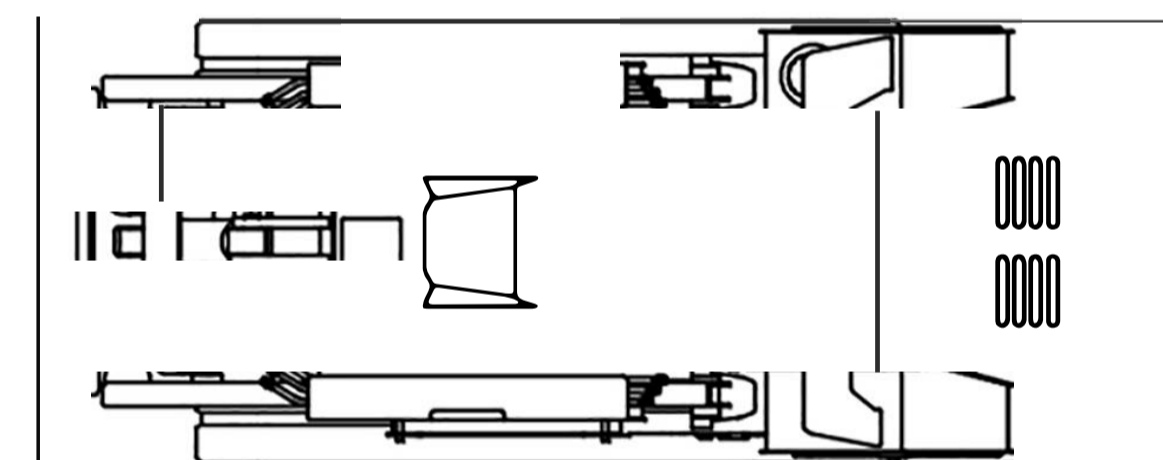
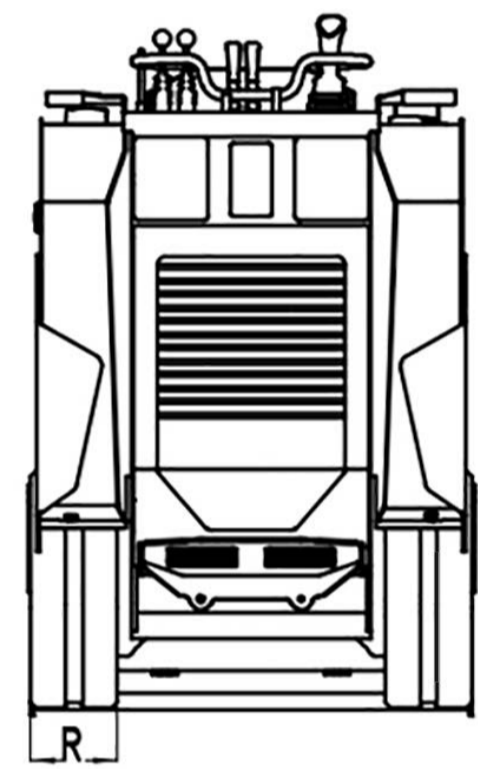
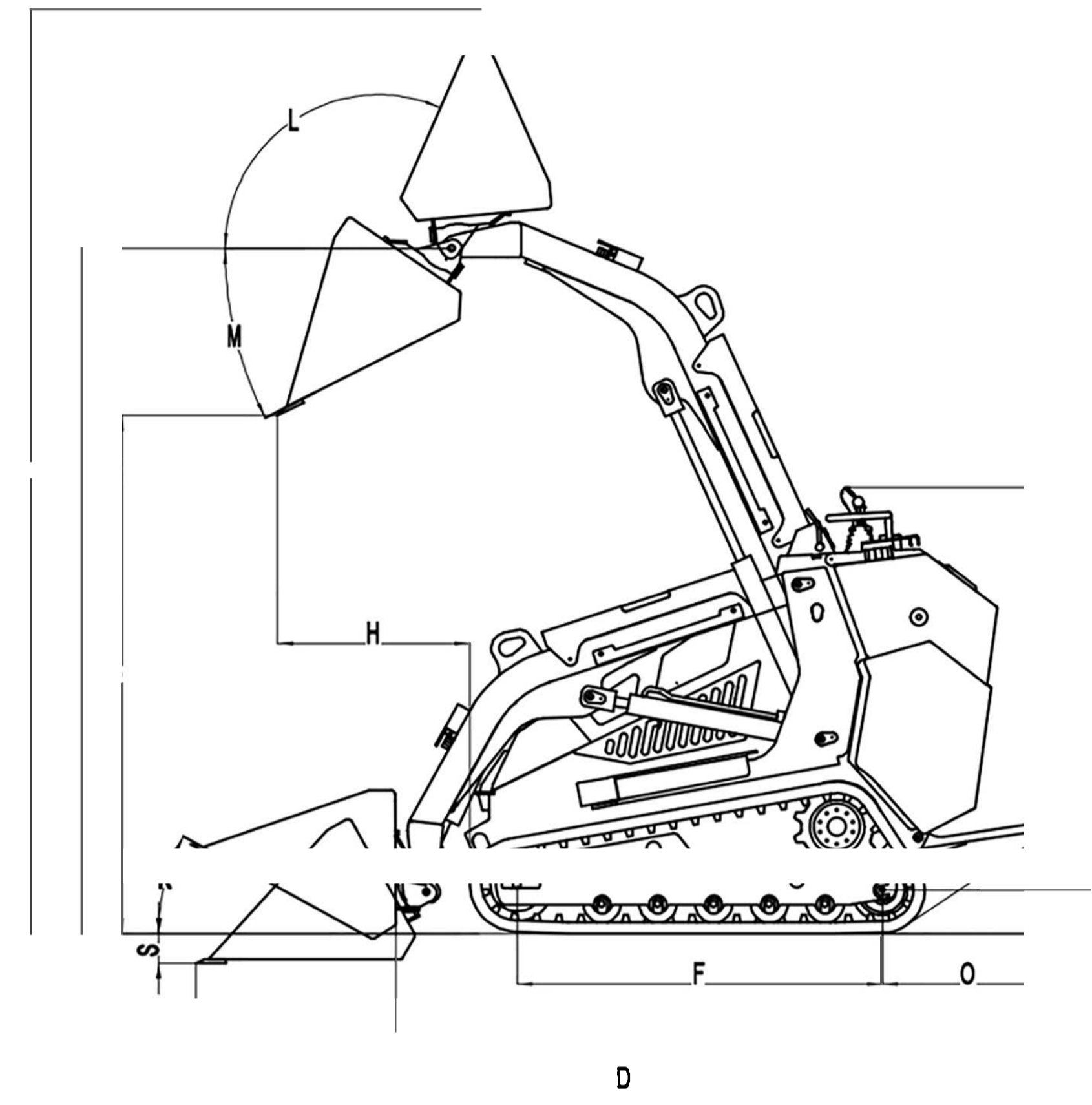

FLUID CAPACITIES

Fuel tank capacity	Lubricating	10.5gal
oil capacity	Hydraulic reservoir capacity	1.3gal
	capacity	9.5gal

BATTERY

SAE reserve capacity rating	110min
SAE cold crank @ 0°F (-18°C)	800amp
Electrical system	s 12V



KS1000

MINI SKID STEER



www.acemachineryinc.com info@acemachineryinc.com

Address: 20181 S State Highway 78, Leonard, TX 75452
 Phone: 1-469-663-0661 (Main) Fax 1-469-663-0691
 All Rights Reserved. Printed in the USA